

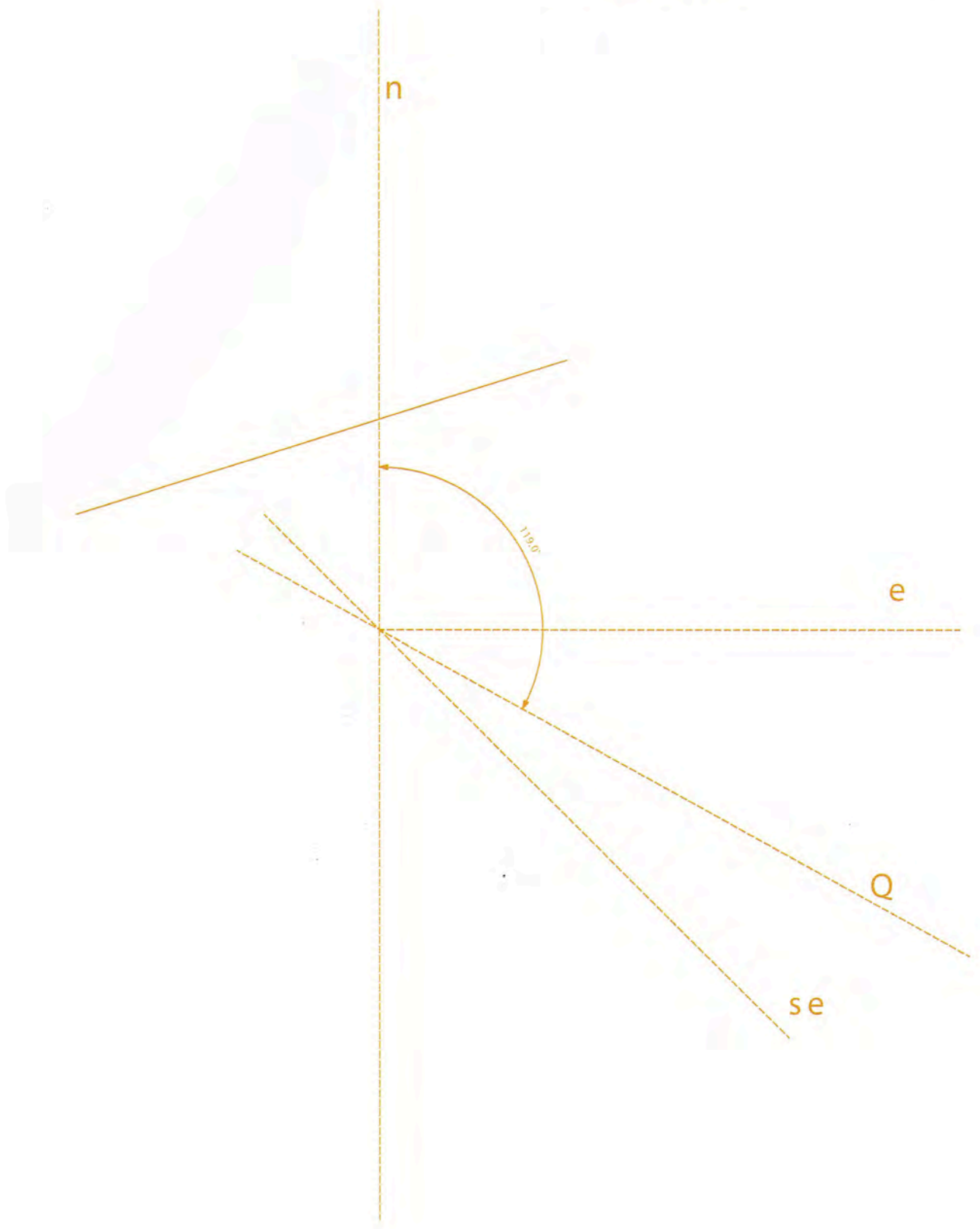

RIBA JOURNAL

DECEMBER 2011/JANUARY 2012 | £5.50 | €19 | US\$20
WWW.RIBAJOURNAL.COM



Sacred geometry
The architecture of faith

ANOTHER SORT OF

Designing a religious building is one of the most deeply satisfying experiences, say four practitioners involved in Christian, Muslim and Jewish schemes. So when they got together they came up with the idea of designing **a sacred space each faith could use** on its separate sabbath. Could this co-operative approach become a reality?

HOLY TRINITY

A CHANCE MEETING and shared interests in sacred buildings got the small team behind Friday Saturday Sunday together to explore how the three Abrahamic religions use space and could, perhaps, share it, writes *Eleanor Young*. After all, land is expensive and the three holy days are, very neatly, consecutive.

Representing Christian church design, with an Anglican bent, is Matthew Lloyd, himself a practising Christian with numerous church projects to his name, including putting the church building on a firmer financial footing. Soraya Khan has found her practice, Theis and Kahn, working first on United Reform Churches and, more recently, a Friend's Meeting House for the Quakers. Shahed Saleem was brought up a Muslim. His makespacearchitects devotes 15-20% of its work to mosques and he is researching a book for English Heritage on the building type's history. His next project is a modern mosque in a warehouse conversion in Aberdeen. Square Feet Architects has found itself working across the Jewish community on schools and community centres as well as on synagogues. Daniel Leon describes many of these as a 'drain', detached from their original community who have now moved on.

Through visiting sacred spaces, a round table discussion and a number of design workshops the group has considered how mosques, churches and synagogues differ, both physically and in terms of client culture and street presence. They give wider expression to those insights in their own columns here as well as drawing together design ideas. Plans for a future for the collaboration range from building a shared sacred space on a barge in the Thames to finding a temporary site for it for next year's London Festival of Architecture. ■

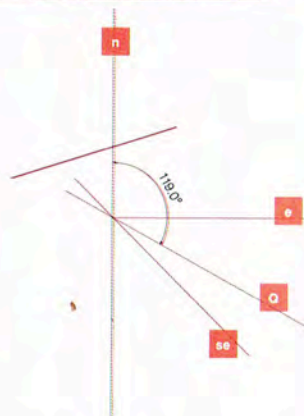
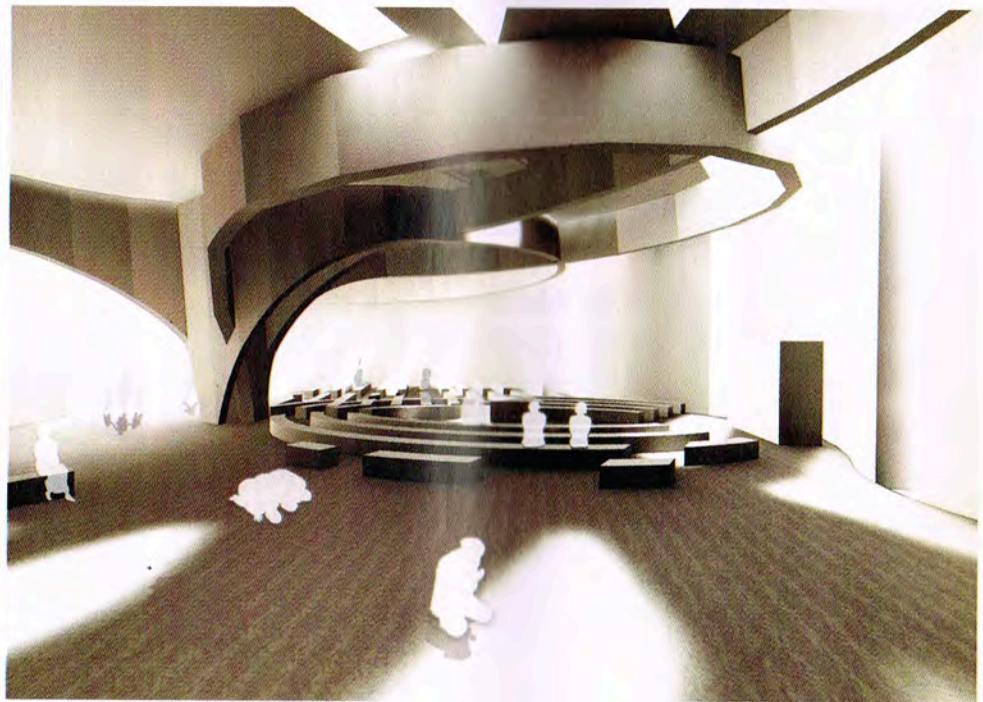

AXIS AND ORIENTATION

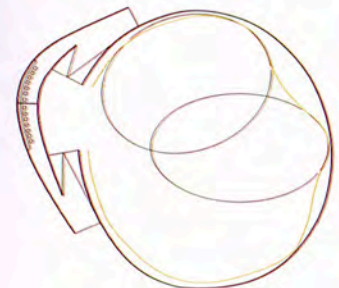

FORM