

Commendations

Projects that make a significant contribution to the quality and appearance of the built environment. Commendation level schemes demonstrate a good standard of architecture or design, sustainability, inclusive design and provide a positive social, cultural, environmental or economic benefit to the local community.

Angel Field

Liverpool, North West

BCA LANDSCAPE, DAN KENYON



This robust landscaping scheme packs a lot into a very small space, providing both public and intimate spaces with delicate and subtle detailing. It enhances the setting of the listed buildings that surround it and provides well used, accessible space with areas for learning and contemplation as well as social gatherings. The design has responded to both a highly sensitive historic environment and an area of social, economic and physical deprivation within which Liverpool City Council regeneration policy is encouraging investment.

Owner
Liverpool Hope University
Applicant
BCA Landscape
Architect/Designer
BCA Landscape
Client
Liverpool Hope University
Main Contractor
Allenbuild
Quantity Surveyor
Tweeds (Liverpool)
Structural Engineer
Steve Hunt Partnership
Services Engineer
TDS

Landscape Designer
BCA Landscape
Soft Landscape Contractor
Lanes Landscapes
Resin Angel Artists
Lucy Glendinning & EWA Ltd
Stone Supplier
Handscape Products
Paving Sub-Contractor
Meldeb Construction Ltd
Tree Suppliers
Lorenz von Ehren
Architects for Lodge
DVA Architects

Barking Central

Barking, Greater London

TIM SCAR, ROB PARRISH



Barking Central is a large mixed-use scheme of seven new buildings including a new Learning Centre, residential apartments, a hotel, retail units, a café, a new town square and an Arboretum. It has provided an increased sense of identity to the centre of Barking with its well used, vibrant and multi functional space having had a positive impact upon the local area, breathing new life into the town centre. Local residents and users were extensively involved in the design and construction of the public space, art and street furniture.

Owner
Redrow Regeneration (Barking) Ltd
Applicant
Allford Hall Monaghan Morris
Architect/Designer
Allford Hall Monaghan Morris
Client
Redrow Regeneration (Barking) Ltd
Main Contractor
Ardmore Construction
Quantity Surveyor
Baqus Nigel Rose (phase 1)
DBK Goynne Adams (phase 2)

Structural Engineer
Buro Happold (Phase 1)
Beattie Watkinson (Phase 2)
Services Engineer
Faber Maunsell (Phase 1)
Atelier Ten (Phase 2)
Landscape Designer
muf architecture/art
Inclusive Design Consultant
Buro Happold
Public Realm Architect
muf architecture/art
Environmental Graphics
Studio Myerscough

Bateman's Row

Shoreditch, Greater London

NICK KANE

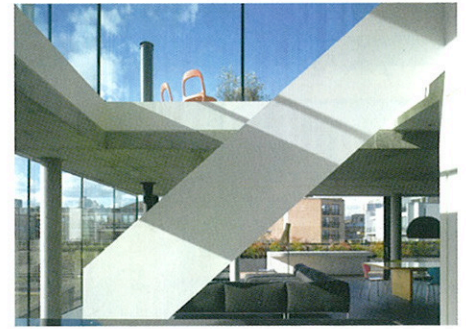

Bateman's Row is a stunning addition to the city, comprising three floors of commercial space and four residential units. With well considered material choices on the outside of the building, in keeping with its surroundings, the interior has a highly urban, inner city feel. An exceptionally well thought out building which contributes both to the streetscape as a catalyst for further regeneration and through public access to the art gallery and retail space. The mixed use creates a vibrant 24 hour usage for the building.

Applicant
Theis + Khan
Architect/Designer
Theis + Khan
Client
Patrick Theis and Soraya Khan
Main Contractor
Silver Interiors Design and Build Ltd
Quantity Surveyor
Stephen Cuddy
Structural Engineer
FJ Samuely and Partners
Landscape Designer
James Catoe Design